

IF IN DOUBT ASK

| ISSUE | DATE       | DRAWN | ECR No | CHECKED | APPROVED |
|-------|------------|-------|--------|---------|----------|
| 1     | 06/02/2020 | DR    |        |         |          |

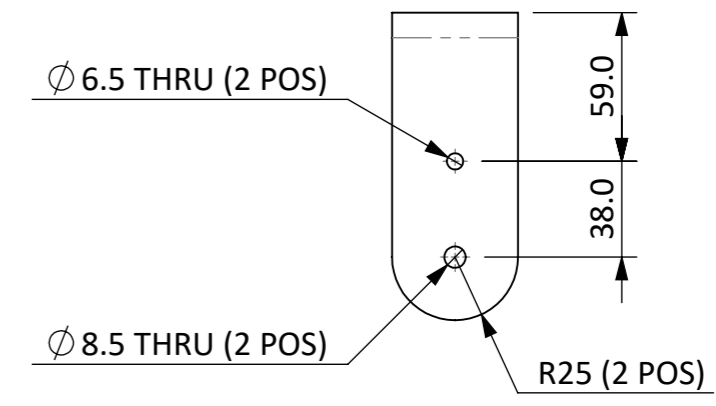
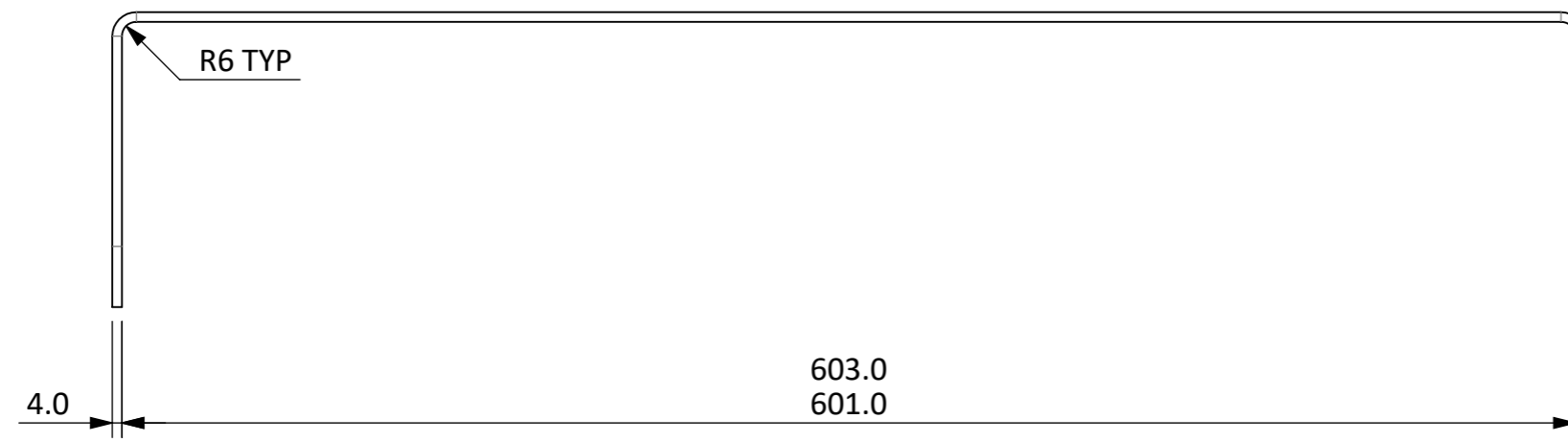
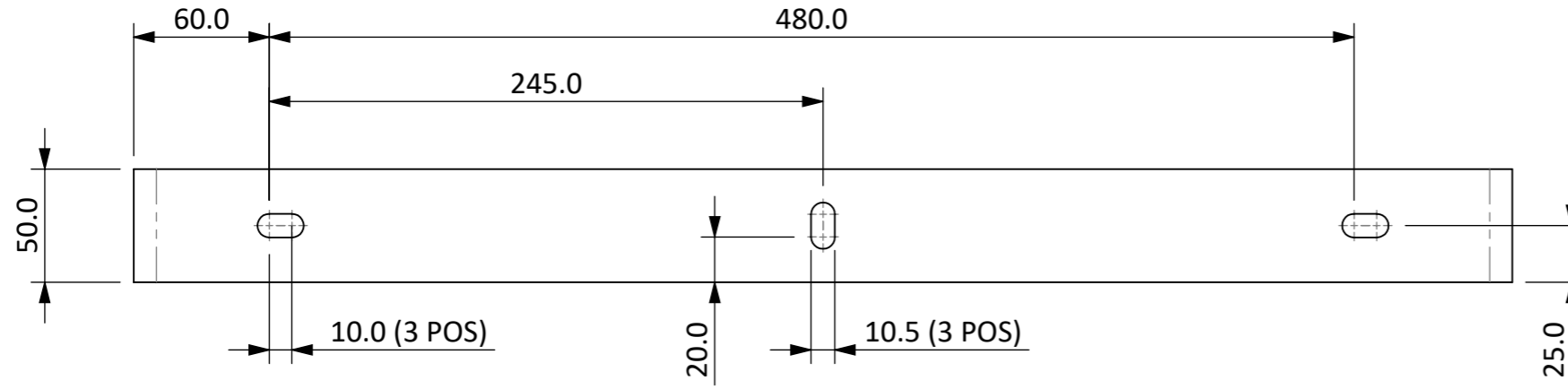
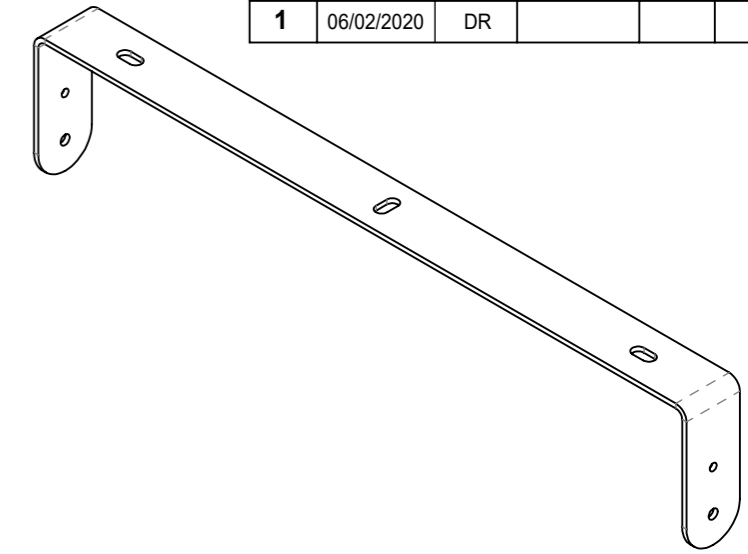

| DIMENSIONS IN MILLIMETRES                             |          |   |            |
|---|----------|---|------------|
| FABRICATION<br><small>UNLESS OTHERWISE STATED</small> |          | MACHINING<br><small>UNLESS OTHERWISE STATED</small> |            |
| UP TO 300mm   | +/-0.2mm | 0, mm   | +/- 0.5 mm |
| 300mm-500mm   | +/-0.5mm | 0,0 mm  | +/- 0.2 mm |
| 500mm - 1m  | +/-1.0mm | 0,00mm  | +/- 0.1mm  |
| 1m - 5m   | +/-2.0mm | 0,000mm   | +/- 0.01mm |
| ANGULAR   | ±1°      | ANGULAR   | ±0,5°      |

|  |                         |                                   |                     |
|--|-------------------------|-----------------------------------|---------------------|
| TITLE:<br><b>VENU 208 YOKE BRACKET</b>         |                         | DRAWING No.<br><b>BR10207-001</b> |                     |
| PROJECT:<br><b>BRACKETS</b>                    |                         | SAP No.<br><b>IT3215</b>          |                     |
| MATERIAL:<br><b>MILD STEEL</b>                 |                         | EST. WEIGHT: (Kg)<br><b>0.16</b>  |                     |
| FINISH:<br><b>POWDER COAT SEMI-GLOSS (HMG)</b> | COLOUR:<br><b>BLACK</b> | TEXTURE:<br><b>SMOOTH</b>         |                     |
| THIRD ANGLE<br>PROJECTION TO BS 8888           | SCALE:<br><b>1:3</b>    | SHT 1<br>OF<br>1 SHTS             | SHEET:<br><b>A3</b> |



REPRODUCTION OF ANY PART OF THIS DOCUMENT IS FORBIDDEN WITHOUT PRIOR PERMISSION FROM VOID ACOUSTICS RESEARCH LTD.  
Registered in England & Wales No. 07533536  
 © DESIGN COPYRIGHT RESERVED.  
 CONFIDENTIAL AND PROPRIETARY INFORMATION OF VOID ACOUSTICS RESEARCH LTD.